

LOAD SENSING PROPORTIONING AND BY-PASS VALVE (LSP & BV) ON-VEHICLE INSPECTION

BR02C-01

1. SET REAR AXLE LOAD

Rear axle load (includes vehicle weight):

2WD	1,100 kg (2,425 lb)
4WD	1,200 kg (2,646 lb)
RZH153R	1,260 kg (2,844 lb)
RZH135R	1,290 kg (2,798 lb)

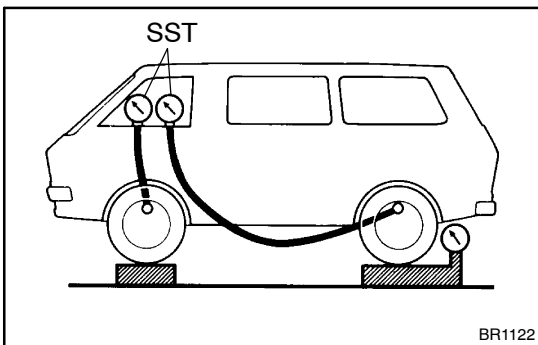

2. INSTALL LSP & BV GAUGE (SST) AND BLEED AIR SST 09709-29018

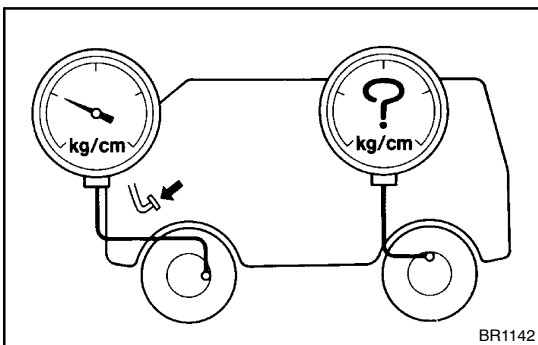

3. Except RZH153R, RZH135R:

RAISE FRONT BRAKE PRESSURE TO 7,845 kPa (80 kgf/cm², 1,138 psi) AND CHECK REAR BRAKE PRESSURE

Rear brake pressure:

2WD	4,795 ± 588 kPa (48.9 ± 6 kgf/cm ² , 696 ± 85 psi)
4WD	6,139 ± 588 kPa (62.6 ± 6 kgf/cm ² , 890 ± 85 psi)

HINT:

The brake pedal should not be depressed twice and/or returned while setting to the specified pressure. Read the value of rear brake pressure 2 seconds after adjusting the specified fluid pressure. If the brake pressure is incorrect, adjust the fluid pressure.

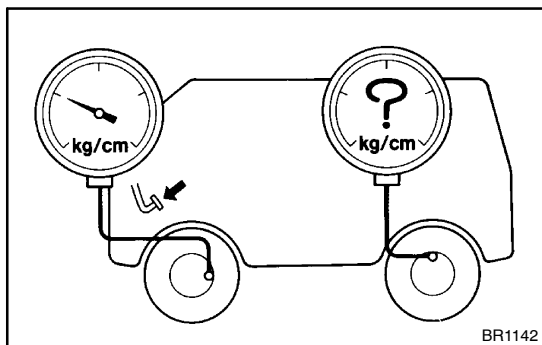

4. **RZH153R, RZH135R:**
RAISE FRONT BRAKE PRESSURE TO 11,768 kPa (120 kgf/cm², 1,707 psi) AND CHECK REAR BRAKE PRESSURE

Rear brake pressure:

7,159 ± 588 kPa (73 ± 6 kgf/cm², 1,038 ± 85 psi)

HINT:

The brake pedal should not be depressed twice and/or returned while setting to the specified pressure. Read the value of rear brake pressure 2 seconds after adjusting the specified fluid pressure. If the brake pressure is incorrect, adjust the fluid pressure.

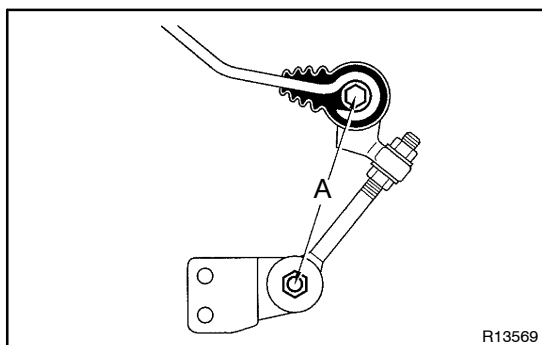

5. **Except RZH153R, RZH135R:**
IF NECESSARY, ADJUST FLUID PRESSURE

- (a) Adjust the length of the No. 2 shackle.

Low pressure – Lengthen A

High pressure – Shorten A

Initial set: 78 mm (3.07 in.)

Adjustment range: 72 – 84 mm (2.83 – 3.31 in.)

HINT:

One turn of the nut changes the fluid pressure as shown in the following table.

Rear brake pressure:

2WD	167 kPa (1.7 kgf/cm ² , 24.2 psi)
4WD	284 kPa (2.9 kgf/cm ² , 41.2 psi)

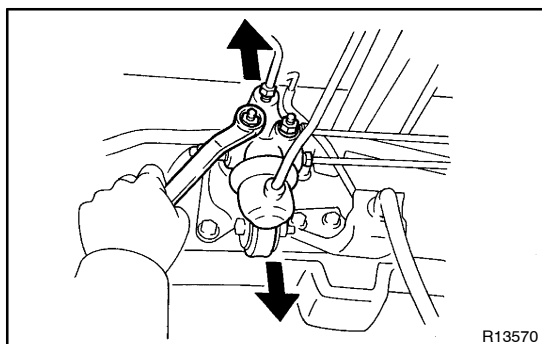

- (b) If the pressure cannot be adjusted by the No. 2 shackle, raise or lower the valve body.

Low pressure – Lower body

High pressure – Raise body

- (c) Torque the nuts.

Torque: 13 N·m (130 kgf·cm, 9 ft·lbf)

- (d) Adjust the length of the No. 1 shackle again.

If it cannot be adjusted, inspect the valve housing.

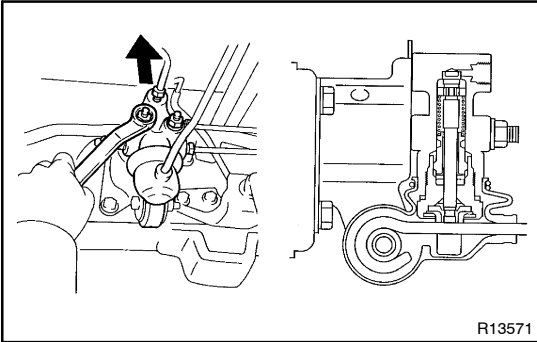

**6. Except RZH153R, RZH135R:
IF NECESSARY, CHECK VALVE BODY**

- (a) Assemble the valve body in the uppermost position.

HINT:

When the brakes are applied, the position will move down about 1 mm (0.04 in.). Even at this time, the piston should not make contact with or move the load sensing spring.

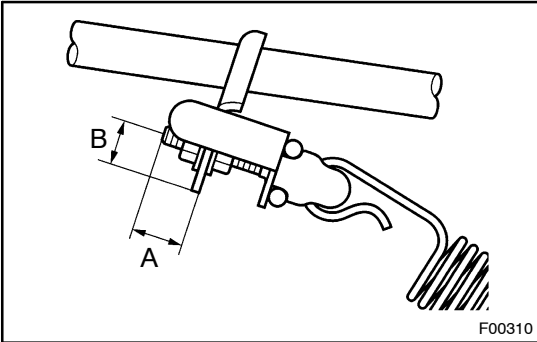

**7. RZH153R, RZH135R:
IF NECESSARY ADJUST FLUID PRESSURE**

- (a) Adjust the length of the shackle No. 2.
- Low pressure – Lengthen A or B
 - High pressure – Shorten A or B

HINT:

One turn of the adjusting nut or 1 mm (0.04 in.) sliding of the adjusting bolt changes the fluid pressure by the following specification.

Adjusting Nut: 294 kPa (3.0 kgf/cm², 43 psi)

Adjusting Bolt: 88 kPa (0.9 kgf/cm², 13 psi)

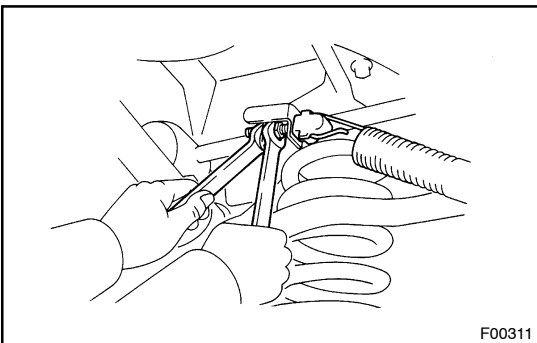

- (b) Torque the nuts.

Torque: 13 N·m (130 kgf·cm, 9 ft·lbf)